

**DESIGN PUBLIC HEARING MAP**  
 PROJECT 36571.1 (I-474)  
 F.A. PROJECT UNAVAILABLE  
**WAKE COUNTY**  
 I-40 ADD LANES FROM WADE AVE.  
 (SR 1728) TO I-40/US164 IN GARY  
 ROLL 2 OF 3

**DESIGN DATA**

Functional Class.	= Interstate
Design Speed	= 75 mph
Max. Superlev.	= 0.08

**LEGEND**

- BUILDINGS
- EXISTING RIGHT OF WAY
- EXISTING ROADWAY
- PROPOSED ROADWAY
- FUTURE ROADWAY
- PROPOSED STRUCTURES, ISLAND, CURB AND GUTTER
- EXISTING STRUCTURES, ISLAND, CURB AND GUTTER TO BE RETAINED
- EXISTING STRUCTURES, ISLAND, CURB AND GUTTER TO BE REMOVED
- LAKES, RIVER, STREAMS AND PONDS
- EXISTING ADT
- FUTURE ADT
- PROPERTY LINES
- NOISE WALL
- NOISE SENSITIVE AREA

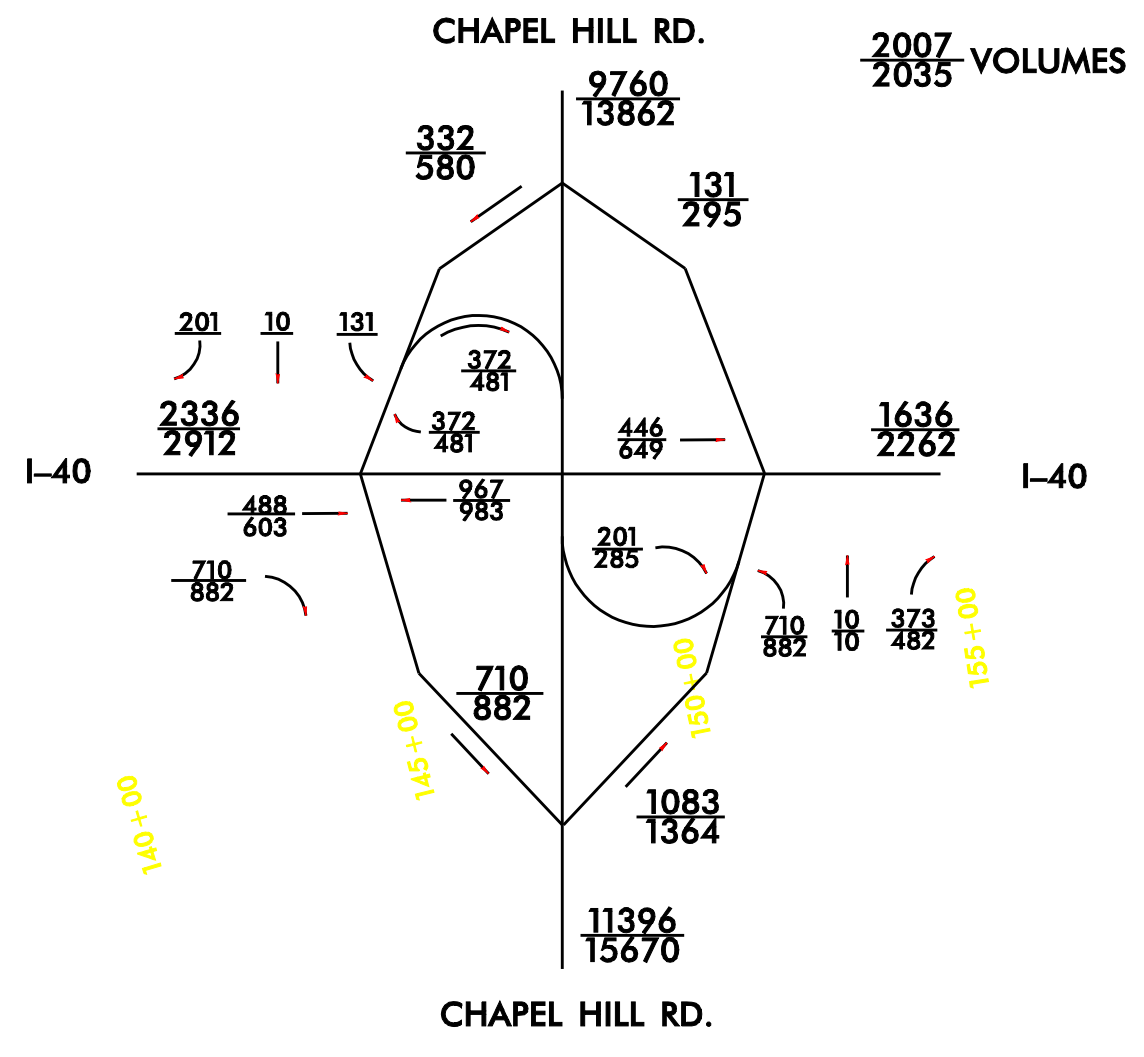
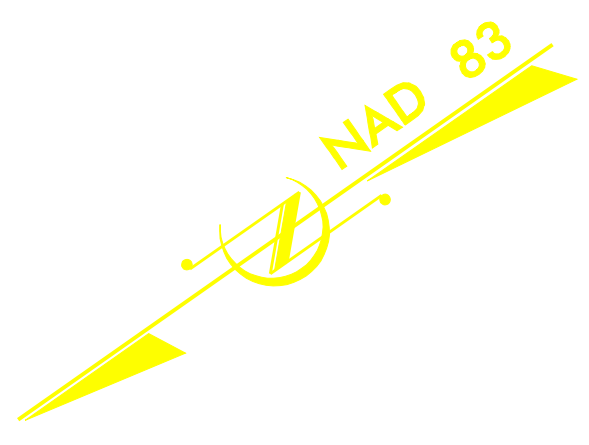
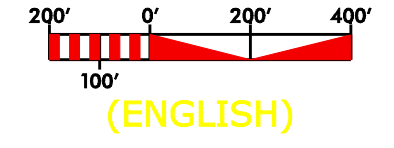

PI STA 87+44.86	PI STA 144+42.40	PI STA 81+83.9	PI STA 176+82.12	PI STA 57+13.14	PI STA 24+71.35
LS = 200.00'	LS = 200.00'	LS = 200.00'	LS = 200.00'	LS = 200.00'	LS = 200.00'
LT = 133.33'	LT = 133.33'	LT = 133.33'	LT = 133.33'	LT = 133.33'	LT = 133.33'
R = 1425.00'	R = 1425.00'	R = 1425.00'	R = 1425.00'	R = 1425.00'	R = 1425.00'
SC = 2%	SC = 2%	SC = 2%	SC = 2%	SC = 2%	SC = 2%
PI = 50'	PI = 50'	PI = 50'	PI = 50'	PI = 50'	PI = 50'

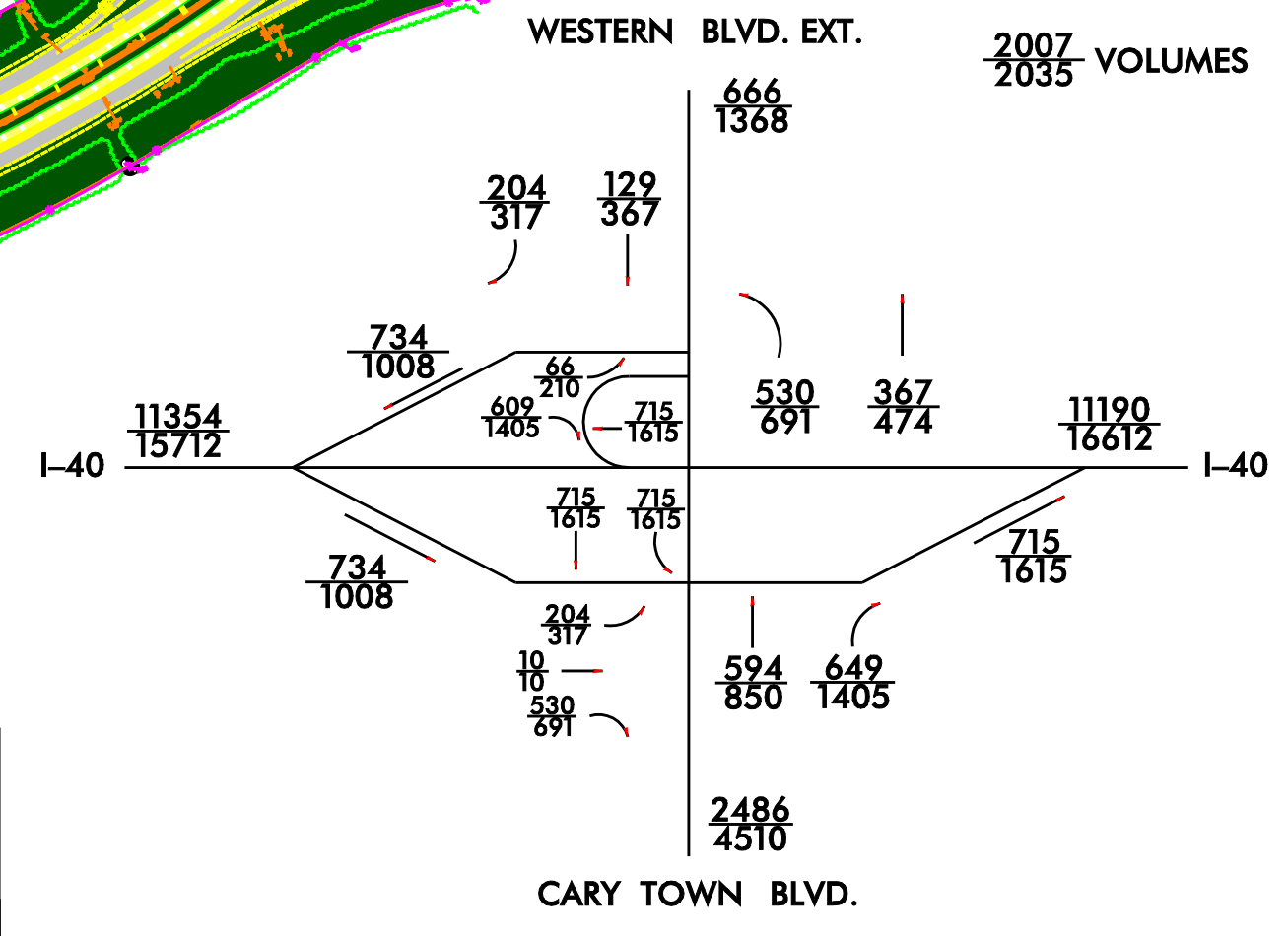
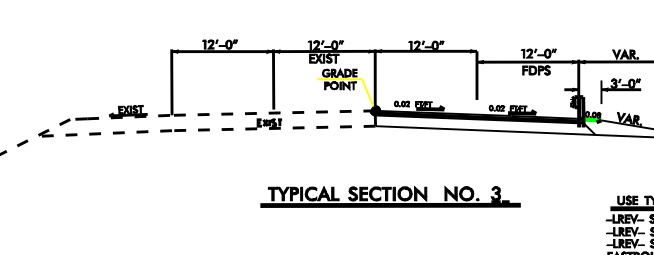
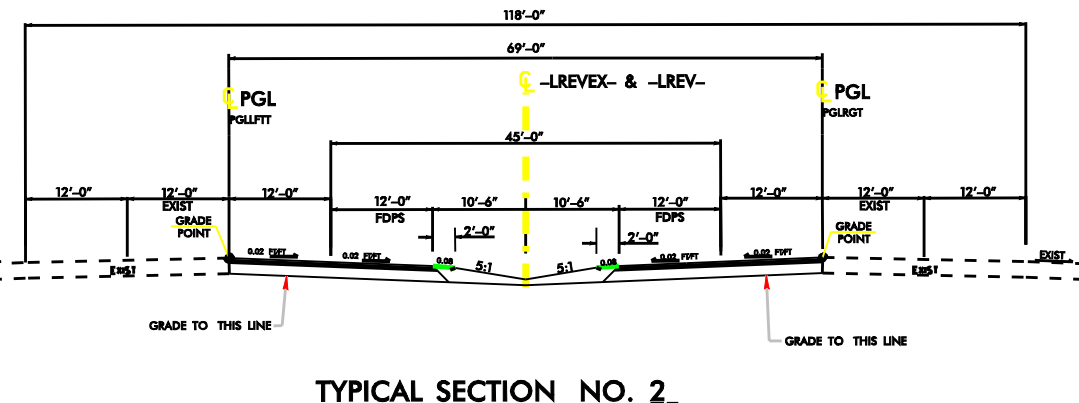
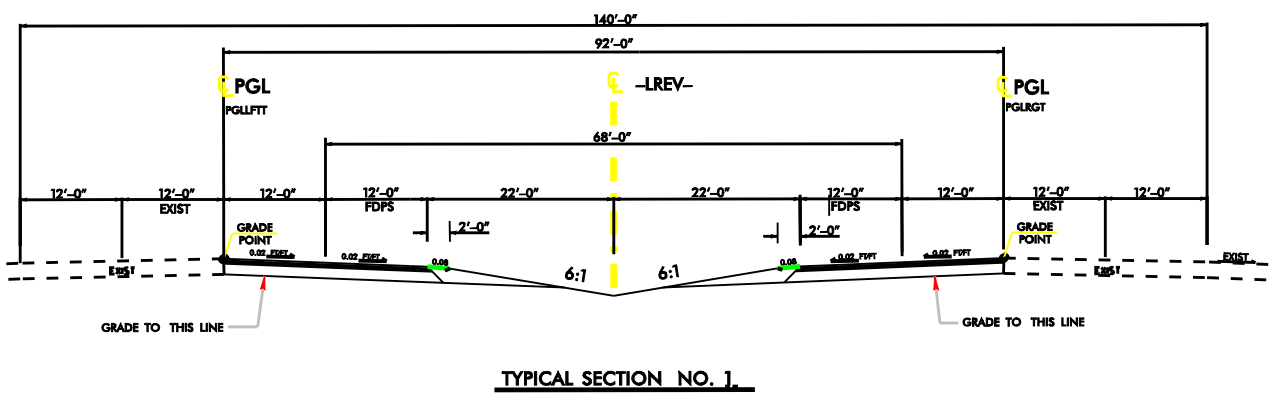
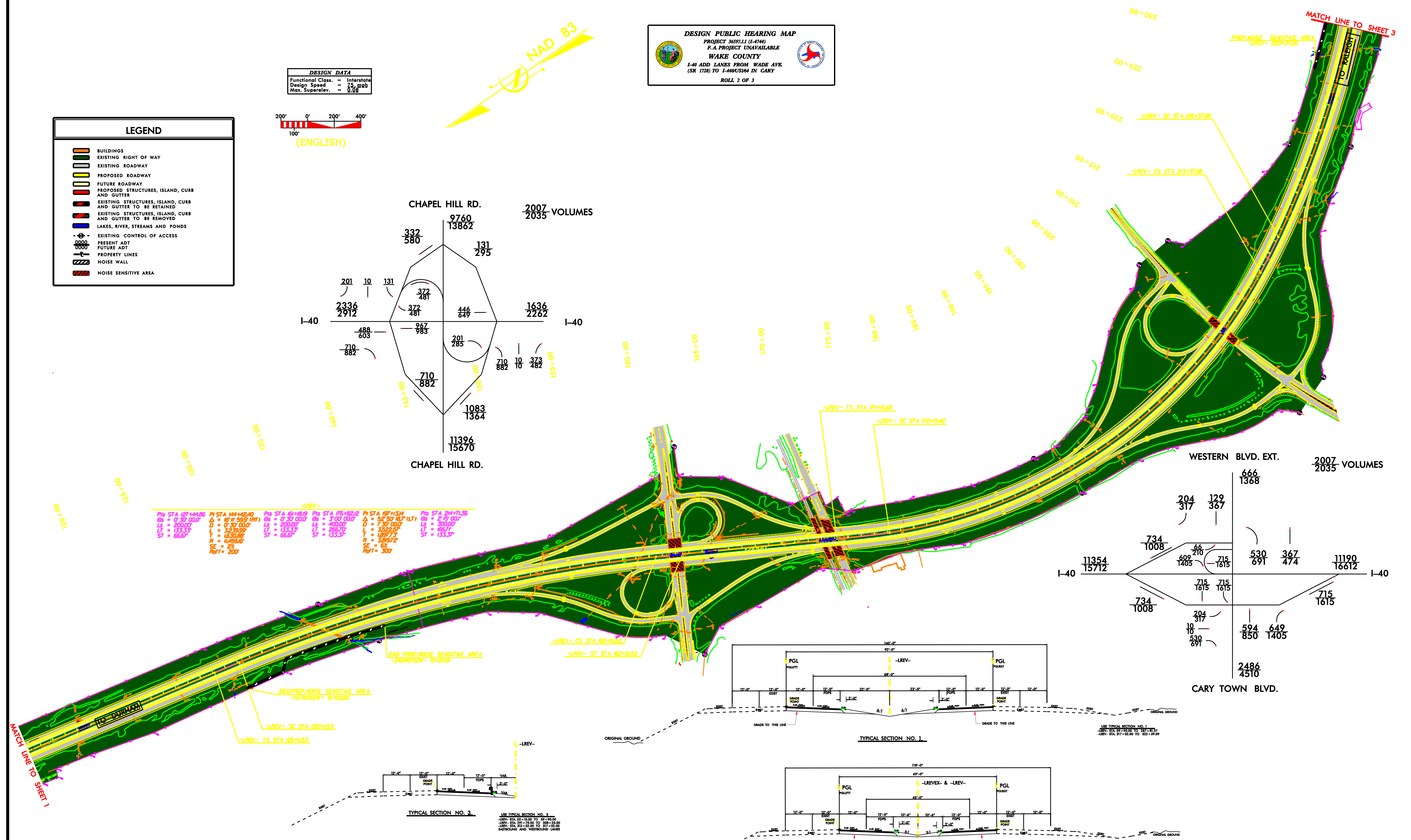

DESIGN PUBLIC HEARING MAP  
 PROJECT 36571.1 (I-474)  
 F.A. PROJECT UNAVAILABLE  
**WAKE COUNTY**  
 I-40 ADD LANES FROM WADE AVE.  
 (SR 1728) TO I-40/US164 IN GARY  
 ROLL 2 OF 3

DESIGN PUBLIC HEARING MAP  
 PROJECT 36571.1 (I-474)  
 F.A. PROJECT UNAVAILABLE  
**WAKE COUNTY**  
 I-40 ADD LANES FROM WADE AVE.  
 (SR 1728) TO I-40/US164 IN GARY  
 ROLL 2 OF 3